

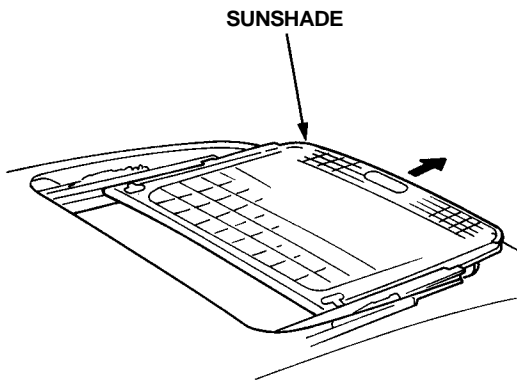

7. Slide the sunshade forward, then remove it.



8. Install the sunshade in the reverse order of removal.  
Make sure the sunshade moves smoothly.

## Guide Plate Replacement

1. Remove the glass bracket.
2. Pry the E-clips and remove the shafts, then separate the glass bracket and drain channel rod.

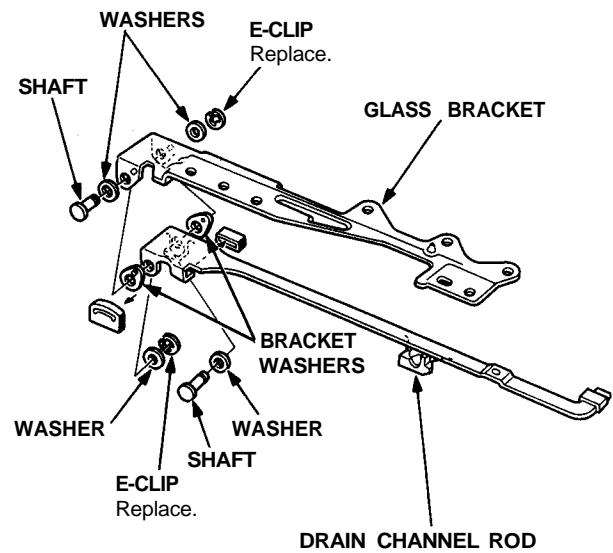

3. Remove the guide plate from the lift-up stopper.

